

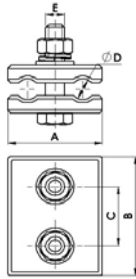

Industrias Arruti

PARALLEL CONNECTORS FOR LINE CONDUCTOR



Material: Alloy A1 . EN-1706 (similar to ANSI A413.0).
Steel parts finish: Hot dip galvanising ASTM A153.

Bolt: ASTM A325.
Nut: ASTM A563.

Reference	ØD Conductor		Dimensions (inch)				Tightening Torque (ftlb)	Weight (lb)
	Min.	Max.	A	B	C	E		
PC-6-14/AM	0,24	0,55	2,36	3,15	1,57	1/2	20	0,99

NOTE: Special fasteners upon request.

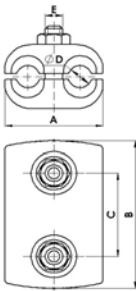

Material: Alloy A1 . EN-1706 (similar to ANSI A413.0).
Steel parts finish: Hot dip galvanising ASTM A153.

Bolt: ASTM A325.
Nut: ASTM A563.

Reference	ØD Conductor		Dimensions (inch)				Tightening Torque (ftlb)	Weight (lb)
	Min.	Max.	A	B	C	E		
PC-12,5/15/AM	0,49	0,59	2,64	4,21	2,36	1/2	35	1,65
PC-15/18,5/AM	0,59	0,73	2,64	4,21	2,36	1/2	35	1,54

NOTE: Special fasteners upon request.

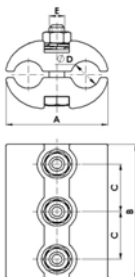

Material: Alloy A1 . EN-1706 (similar to ANSI A413.0).
Steel parts finish: Hot dip galvanising ASTM A153.

Bolt: ASTM A325.
Nut: ASTM A563.

Reference	ØD Conductor		Dimensions (inch)				Tightening Torque (ftlb)	Weight (lb)
	Min.	Max.	A	B	C	E		
GPC-3 Ø17-20/AM	0,67	0,79	3,15	4,41	1,57	1/2	20	2,2
GPC-3 Ø20-23/AM	0,79	0,91	3,15	4,41	1,57	1/2	20	2,09
GPC-3 Ø23-25/AM	0,91	0,98	3,15	4,41	1,57	1/2	20	1,98
GPC-3 Ø25-27/AM	0,98	1,06	3,15	4,41	1,57	1/2	20	1,94
GPC-3 Ø27-30/AM	1,06	1,18	3,94	4,41	1,57	1/2	20	2,43
GPC-3 Ø30-33/AM	1,18	1,3	3,94	4,41	1,57	1/2	20	2,31

NOTE: Special fasteners upon request.