



REFERENCE
MRCP3

Aluminum terminal for cable to flatbar.

**Material:** Casting - Aluminum Alloy

**Hardware:** Stainless or Galvanized Steel

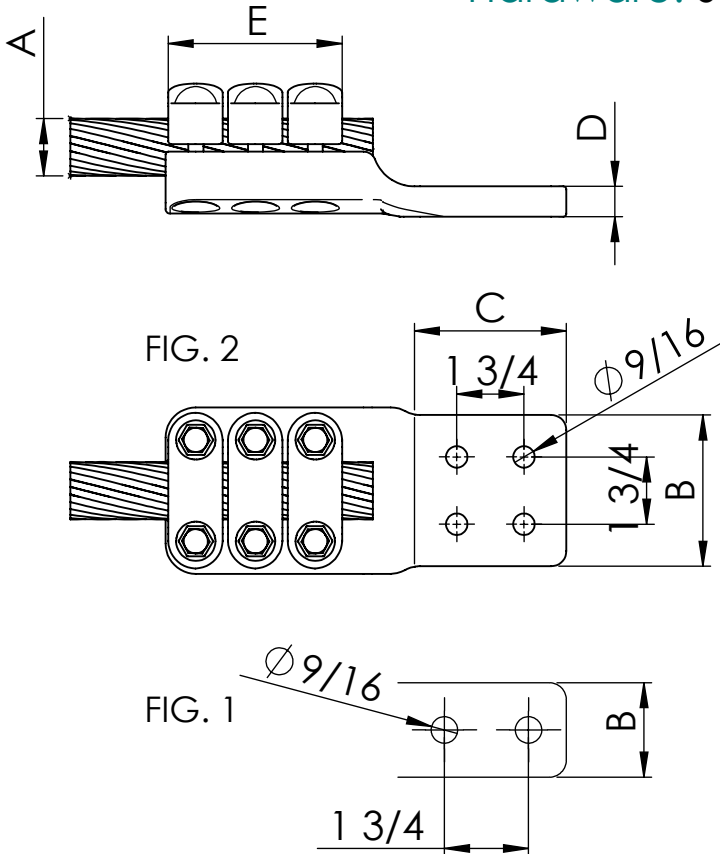

Note: \*other flat dimensions & hole patterns available\*

CATALOG NUMBER	FIG NO.	CONDUCTOR RANGE (A)		DIMENSIONS				Tightening torque (ft.lb)
		Min.	Max.	B	C	D	E	
MRCP3-302N	1	1.06	1.18	2	3	0.79	5.12	20
MRCP3-303N	2	1.06	1.18	3	3	0.79	5.12	20
MRCP3-304N	2	1.06	1.18	4	4	0.79	5.12	20
MRCP3-322N	1	1.22	1.26	2	3	0.79	5.12	20
MRCP3-323N	2	1.22	1.26	3	3	0.79	5.12	20
MRCP3-324N	2	1.22	1.26	4	4	0.79	5.12	20
MRCP3-352N	1	1.30	1.38	2	3	0.79	4.53	20
MRCP3-353N	2	1.30	1.38	3	3	0.79	4.53	20
MRCP3-354N	2	1.30	1.38	4	4	0.79	4.53	20
MRCP3-382N	1	1.42	1.54	2	3	0.79	4.53	20
MRCP3-383N	2	1.42	1.54	3	3	0.79	4.53	20
MRCP3-384N	2	1.42	1.54	4	4	0.79	4.53	20
MRCP3-432N	1	1.57	1.69	2	3	0.79	4.53	20
MRCP3-433N	2	1.57	1.69	3	3	0.79	4.53	20
MRCP3-434N	2	1.57	1.69	4	4	0.79	4.53	20