



REFERENCE
LD3P

90° connector duplex copper cable to copper flatbar.

Material: Casting - Bronze

Hardware: Stainless or Galvanized Steel

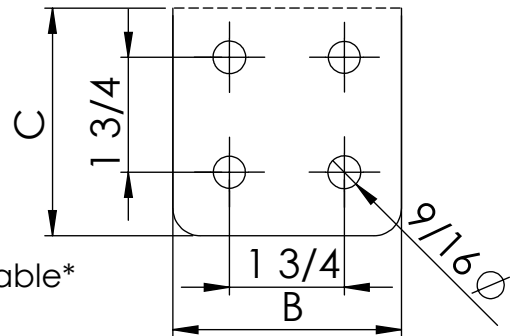
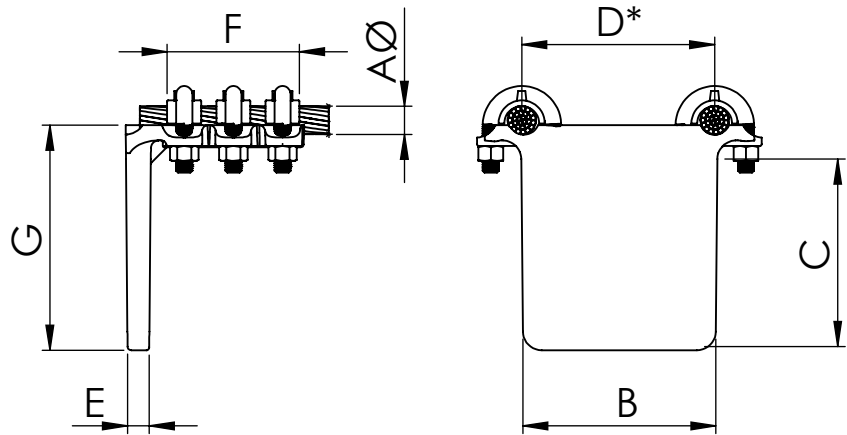
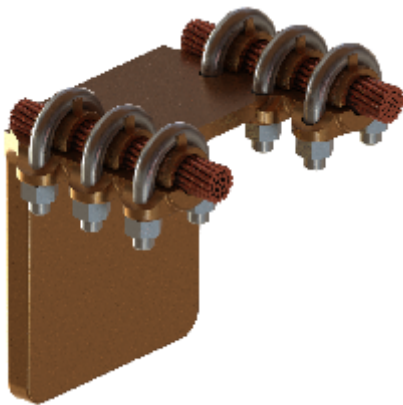

Note: *other flat dimensions & hole patterns available*

*D: space between cables 1=4", 15=6"

CATALOG NUMBER	CONDUCTOR RANGE	DIMENSIONS						Tightening torque (ft.lb)
		A	B	C	D	E	F	
LD3P.*-1503N	0.49-0.61	3	3		0.31	2.87	4.49	15
LD3P.*-1504N	0.49-0.61	4	4		0.31	2.87	5.28	15
LD3P.*-2503N	0.69-0.79	3	3		0.35	3.15	4.57	15
LD3P.*-2504N	0.69-0.79	4	4		0.35	3.15	5.35	15
LD3P.*-4004N	0.89-1.02	3	3		0.39	3.35	4.61	15
LD3P.*-4003N	0.89-1.02	4	4		0.39	3.35	5.39	15
LD3P.*-5003N	1.14	3	3		0.47	3.70	4.65	20
LD3P.*-5004N	1.14	4	4		0.47	3.70	5.43	20